



ADDENDUM MANUAL READ FIRST!

⚠ Carefully read through this Addendum Manual before you begin reading the original STREET WEAPON instruction manual and assembling your *RALLY WEAPON* kit. You should read through this Addendum Manual completely and mark each step in the Standard Manual that is found in this manual. When the marked step is reached in the Standard Manual, refer to this Addendum Manual for new assembly instructions pertaining to the *RALLY WEAPON*.

HOW TO USE THIS ADDENDUM

In order to ensure proper assembly of your *RALLY WEAPON*, it is important to know when it will be necessary to refer to this manual as you progress through the assembly process using the standard STREET WEAPON Owner's Manual. It is recommended that you mark all of the steps listed below in the standard manual with a highlighter or other type of mark. When these steps are reached in the standard manual, you should refer to the instructions for that particular step in this addendum manual. For your convenience, all of the necessary steps are listed below and are separated by bag.

Mark the following steps in the standard STREET WEAPON Manual:

Bag B

Figure 16, Step 14.

Bag D

Figure 40, Step 11.

Bag E

Figure 54, Step 4.

Figure 61, Steps 16 through 22.

Bag F

Figure 67, Steps 6.

Figure 68, Steps 10, 11, 13.

Figure 70, Step 18.

Figure 71, Steps 23.

Figure 73, Step 36 and 37.

Bag G

Figure 74, Step 2 through 4.

Bag H

Figure 85, Step 29 through 32.

Figure 86, Steps 33 and 34.

BAG B

Figure 16

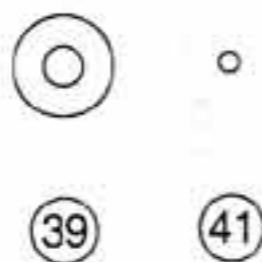

Step 14. Grease the thrust washer (39) well with white thrust bearing/assembly grease (40) and place the eight 5/64" thrust bearing balls (41) on top of the washer (39), around the diff screw (38). Apply more white thrust bearing/assembly grease (40) to the tops of the thrust bearing balls (41). Place the second thrust washer (39) over the screw (38) and against the thrust bearing balls (41).

⚠ IMPORTANT NOTE: Ensure that all eight thrust bearing balls remain in place between the two washers, around the diff screw.

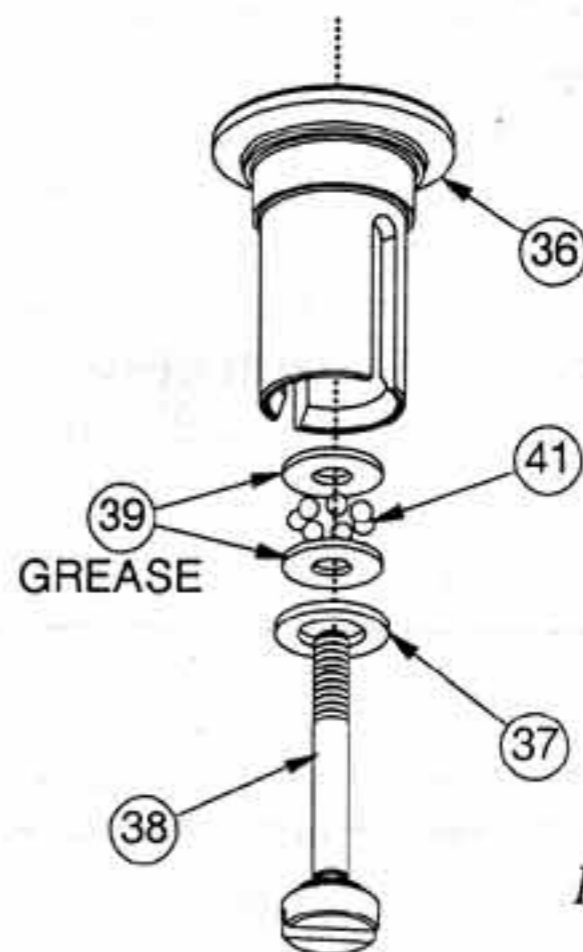

Figure 16

BAG D

Figure 40



(72)

- Step 11. Insert a 4-40 x 7/8" cap-head screw (72), from the rear, through the middle hole on top of the shock tower (71) on each side. Thread a top shock mount bushing (73) onto each of the two screws (72), and tighten.

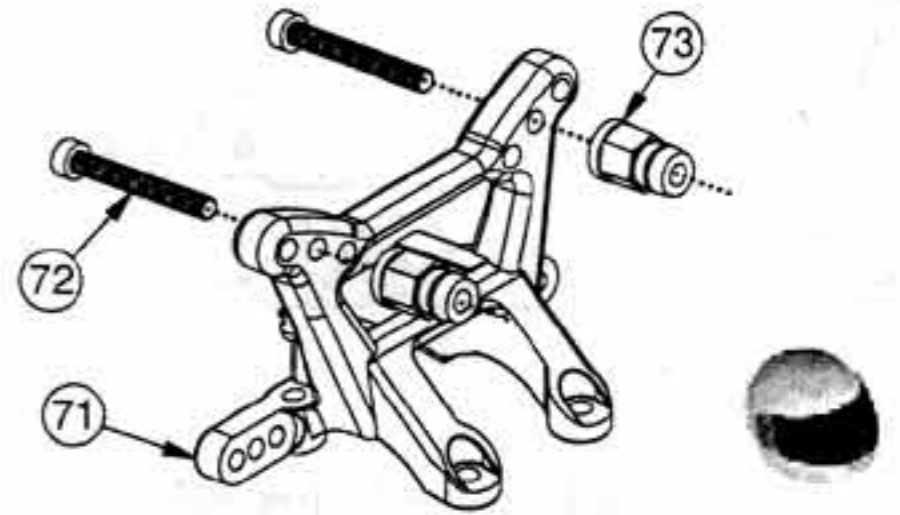

Figure 40

BAG E

Figure 54



(85)

- Step 4. Thread a 1/4" ball stud (85) into each of the #5.5 holes on the bottom of the rear shock tower (97). Mount the ball studs (85) from the rear as shown. Place a foam thing (91) over the two ball studs (85).

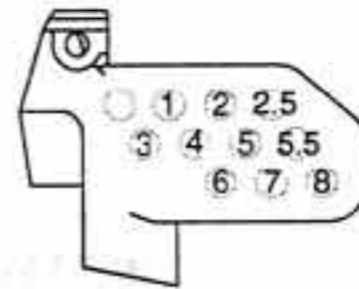

Figure 54A

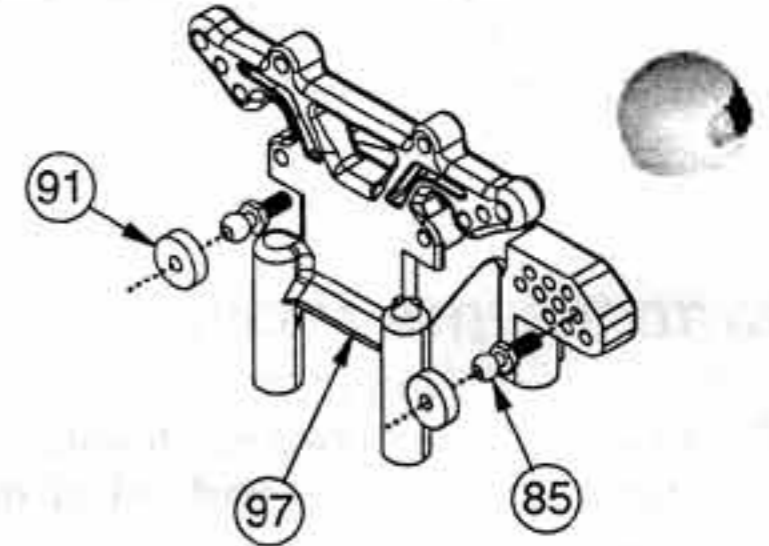
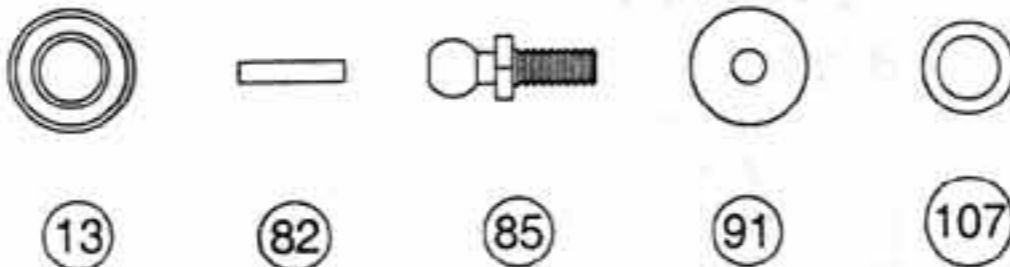

Figure 54

Figure 61



- Step 16. Press a 3/16" x 3/8" bearing (13) into each side of the right rear hub (106).

**NOTE: If the bearings only have one Teflon™ seal (tan, woven looking) in them, position the Teflon™ seal to the outside.*

- Step 17. Thread a 1/4" ball stud (85) into the #5 hole in the rear hub (106). The ball stud (85) should be threaded into the side of the hub (106) with the recessed area.

- Step 18. Place a foam thing (91) over the ball stud (85).

- Step 19. Slide the rear axle (104) through the bearings (13) from the inside of the hub (106).

- Step 20. Place a rear axle spacer (107) over the rear axle (104), against the outside bearing (13).

- Step 21. Secure the rear axle (104) and spacer (107) by inserting a 1/16" x 3/8" spirol pin (82) through the small hole in the rear axle (104). The pin (82) should be centered in the rear axle (104).

- Step 22. Repeat Steps 16 through 21 for the left rear hub (109).

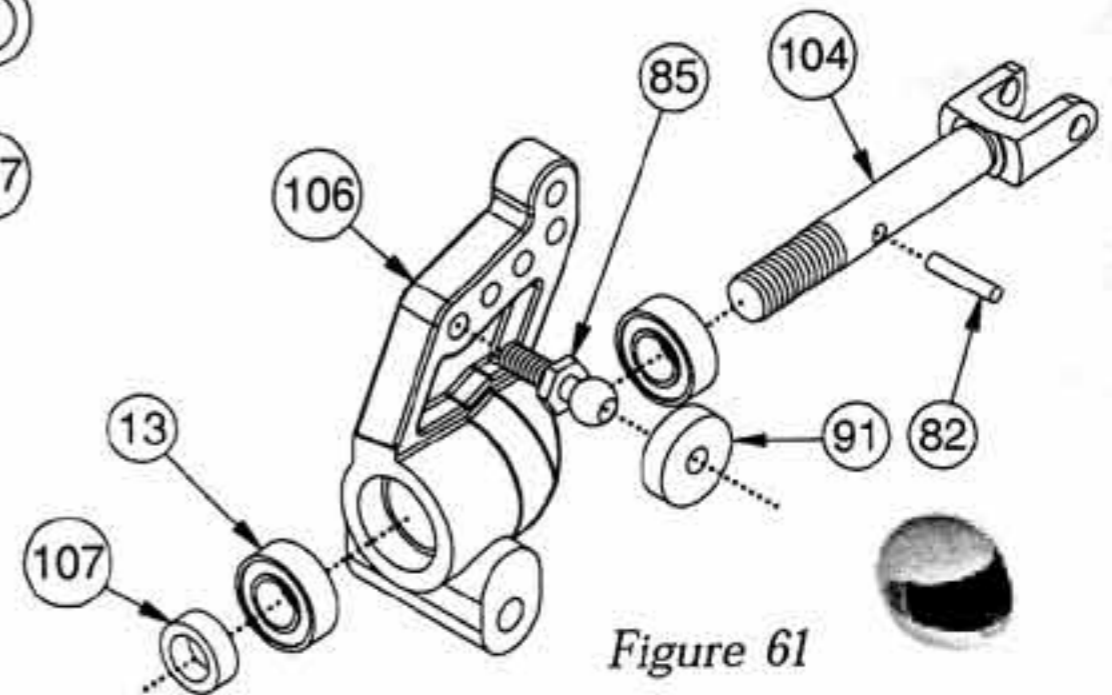

Figure 61



Figure 61A

BAG F

Figure 67

- Step 6. Ignore step 6 in the STREET WEAPON manual. No spacers are used on the outside of the shocks. Go to Step 7 and continue assembly.

BAG F (continued)

Figure 68



(67)

- ❑ Step 10. Snap a 1/8" E-clip (67) into the groove closest to the cartridge on two of the shock shafts (117). These will be used in the rear of the car.
- ❑ Step 11. Before attaching the E-clips to the remaining two shock shafts (117), slide two 'A' shock spacers (119) (the smaller of the two spacers, marked 'A') over the shaft (117) and next to the cartridge. Once the spacers are in place, snap a 1/8" E-clip (67) into the groove closest to the cartridge on both front shock shafts (117). These will be used in the front of the car.
- ❑ Step 13. Slide a black, #57 shock piston (122) onto each of the two rear shock shafts (117) until the piston rests against the E-clip (67). Secure the pistons (122) to the shafts (117) with a second E-clip (67).

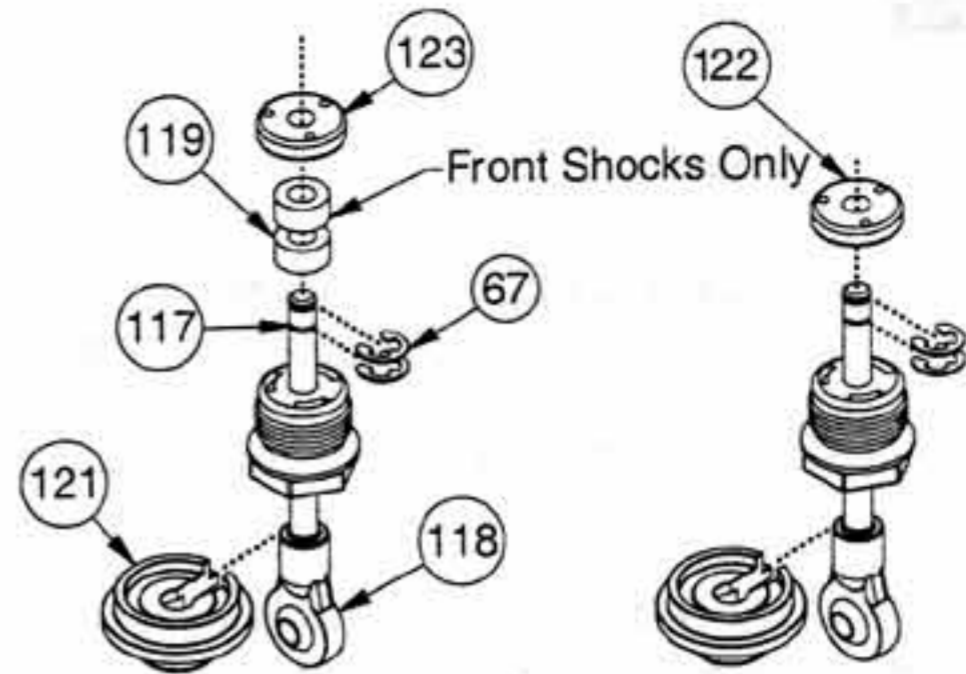

Figure 68

Figure 70

- ❑ Step 18. Slide a silver spring (125) over each of the shocks so that the spring rests on the spring cup (121).

Figure 70

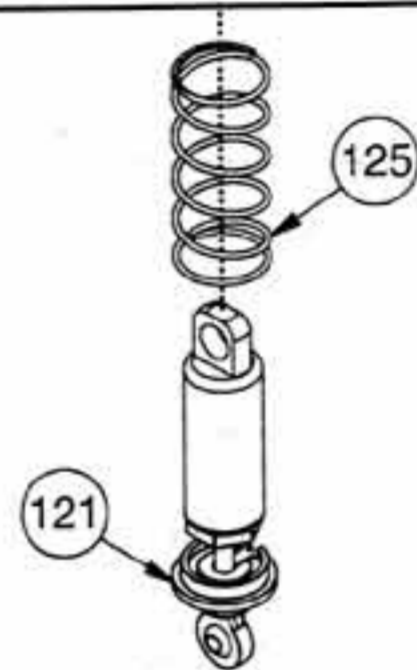

Figure 71



(47)

- ❑ Step 23. Attach the bottom of the shock to the rear arm (93), (96) by threading the 4-40 x 1/2" cap-head screw (47) into the inside shock mounting hole on the arm (93), (96).

Figure 71



Figure 73



(135)

- ❑ Step 36. Position a body mount swivel (134) over each of the two front body posts (132). Align the holes in the swivel (134) with the 5th hole up on the post (132). Secure the swivel (134) to the post (132) by inserting a body clip (135) all the way through the hole in the swivel (134), the post (132), and the hole in the opposite side of the swivel (134).
- ❑ Step 37. Repeat Step 36 for the rear body mounts (130), (131). This time, align the swivels (134) with the 4th hole down on the body mounts (130), (131).

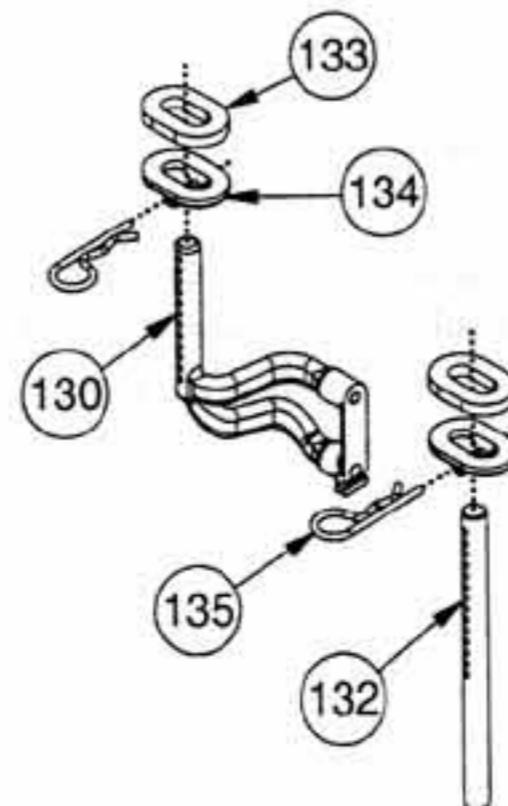

Figure 73

BAG G

Figure 74



139

- ❑ Step 2. Ignore Steps 2 and 3. Different tire inserts are used.
- ❑ Step 4. Insert the foam tire liners (138) into each tire (136). Pull tires over each wheel (137) and squeeze the tire (136) to properly seat it in the grooves of the wheel (137). Make certain that the foam liners (138) are not pinched between the tires (136) and the wheels (137).

! IMPORTANT NOTE: The tires included with the Rally Weapon are directional. You must install two tires to the wheels in one direction, and the remaining two tires in the other direction. When installed correctly, the tread on all four tires will face the same direction when the tires and wheels are installed on the car.

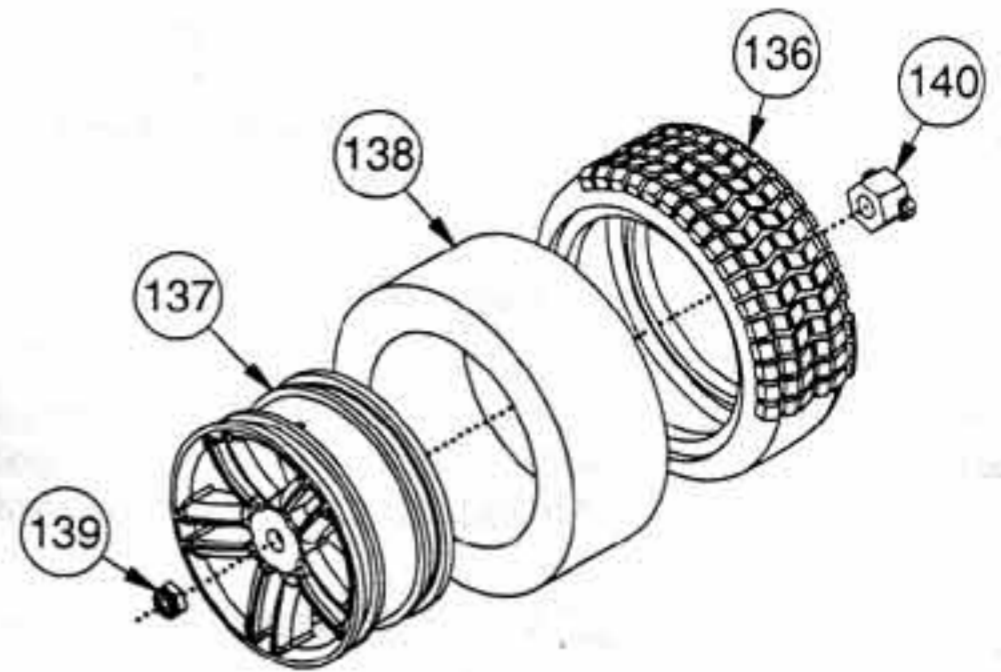
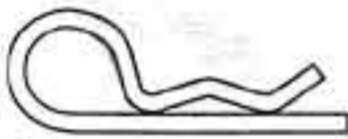

Figure 74

BAG H

Figure 85



135

- ❑ Step 29. Trim the body (159) and wing (160) along the trim lines as shown.
- ❑ Step 30. Make five 3/16" diameter holes in the areas on the hood, rear window, and roof of the body (159) that are marked with dimples or small circles.

**NOTE: If the holes are a little tight when installing the body, enlarge them slightly with a hobby knife or round file.*

- ❑ Step 31. Ignore this step in the Street Weapon manual.
- ❑ Step 32. Attach the body (159) to the rolling chassis and secure the body with four body clips (135): Two through the front body mount posts (132); and two through the rear body mounts (130), (131).

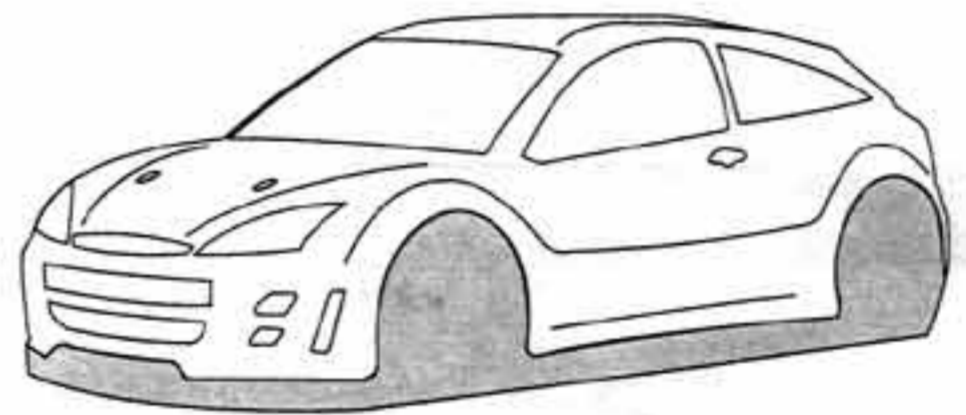

Figure 85

Figure 86

- ❑ Step 33. Mount wing side dams to wing using double-sided tape as shown in Fig. 86.
- ❑ Step 34. Mount the wing to the back of the body where there are two recessed areas using double-sided tape as shown in Fig. 86A.

**NOTE: There are screws and nuts also included in the kit if you want to replace the servo tape to mount the wing to the body.*

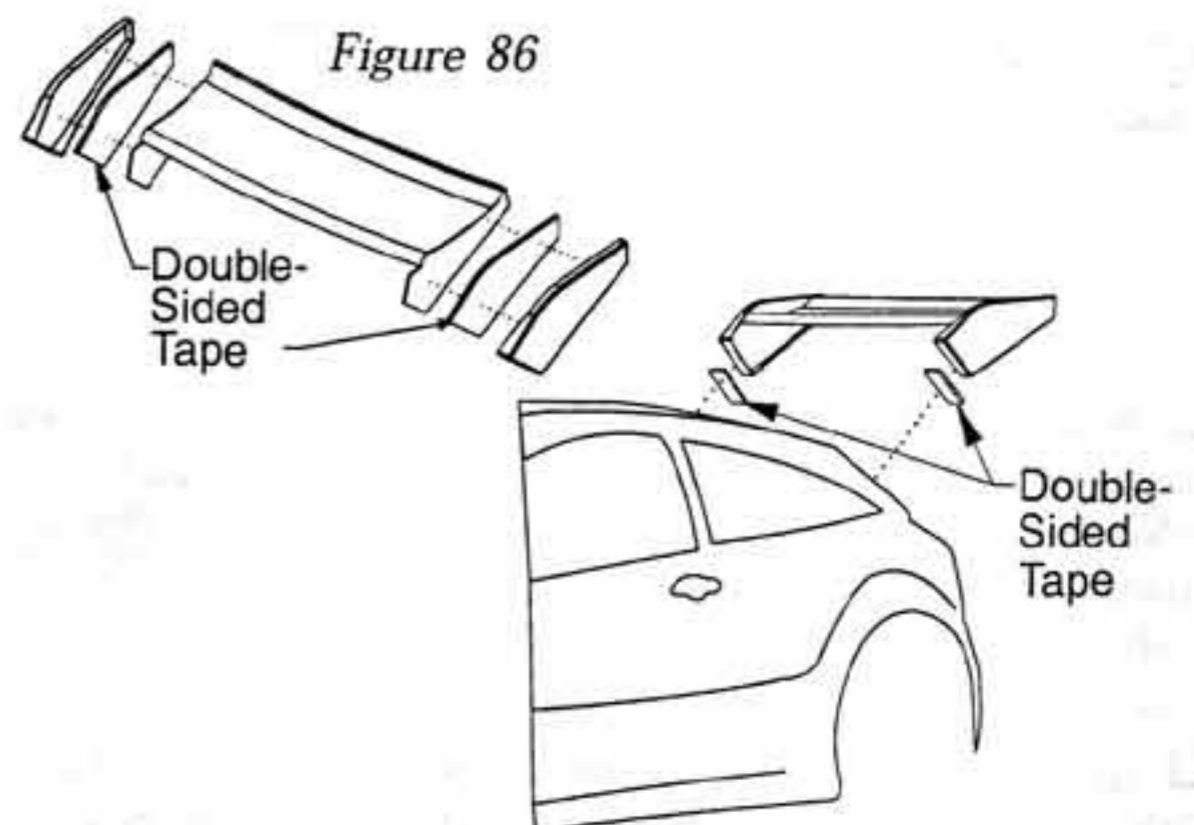
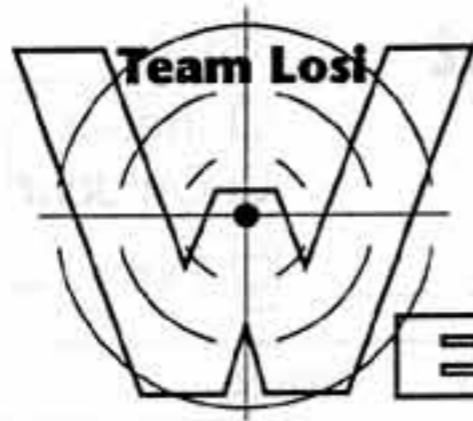

Figure 86A



RALLY WEAPON

A-0210 Rally Weapon Kit w/ Bearings

UPDATED PARTS LIST

<u>KEY #</u>	<u>KIT/PART DESCRIPTION</u>	<u>PART NO.</u>	<u>SPARE PARTS DESCRIPTION</u>
8	Spur Gear	A-3931	82 Tooth, 48 Pitch (Non-Slipper) Spur Gear
41	5/64" Thrust Bearing Balls	A-3099	Full Compliment Thrust Bearing Set
106	Right Rear Hub	A-9804	Lowered Rear Hubs (Rally Weapon)
109	Left Rear Hub	A-9804	Lowered Rear Hubs (Rally Weapon)
110	Rear Hub Spacers	A-9804	Lowered Rear Hubs (Rally Weapon)
117	Shock Shafts	A-5091	.48" Shock Set with Springs
124	Shock Body	A-5091	.48" Shock Set with Springs
125	Front Shock Spring	A-5104	1.4" (3.0 rate) Rally Car Spring Set (4)
126	Rear Shock Spring	A-5104	1.4" (3.0 rate) Rally Car Spring Set (4)
136	Tire	A-7720	Rally Weapon Wheels and Tires (pr.)
138	Tire Foam	A-7720	Rally Weapon Wheels and Tires (pr.)
159	Body	N/A	N/A
160	Wing	N/A	N/A



TEAM LOSI

Always Racing Towards The Future.

Team Losi, Inc., 13848 Magnolia Ave., Chino, CA 91710
Phone: (909) 465-9728 • Fax: (909) 590-1496
www.TeamLosi.com • Feedback@TeamLosi.com



RALLY LEAPON

Setup Sheet

Driver: _____

Date: _____

Track: _____

- Indoor
- Outdoor

- Carpet
- Concrete
- Asphalt

- Sealed
- Smooth
- Rough

(Circle or Check the Appropriate Settings)

Notes: _____

Toe In _____ °
 Out _____ °

Ride Height _____

Camber - _____ °
 + _____ °

Caster Stock _____ °
 Other _____ °

Sway Bar No
 Yes size _____

Steering Bellcranks

Inner Outer

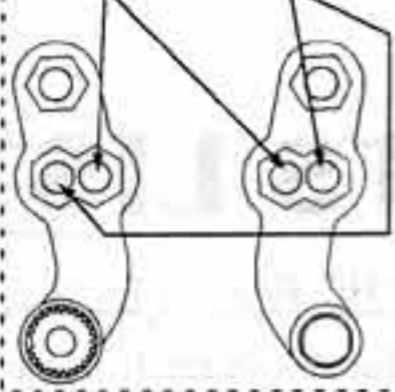

Rod Length
 Stock
 Other _____

Front Shocks

Oil: _____

Piston: _____ Standard / Drilled

Spring: _____

Limiters: Inside- _____ Outside- _____

of washers _____

Hole in Carrier
 Top
 Bottom

of washers _____

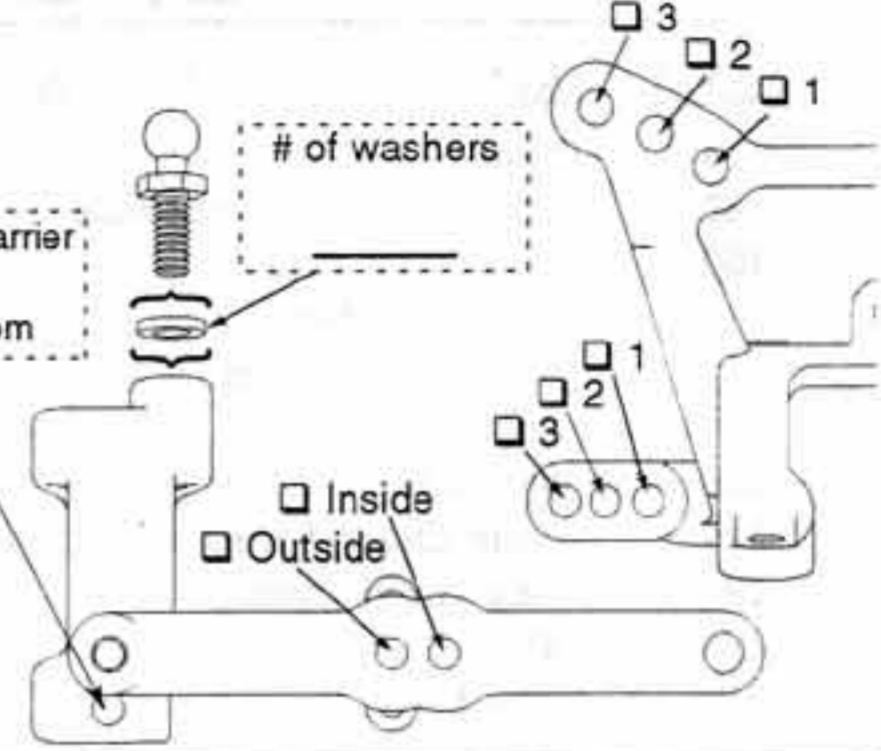
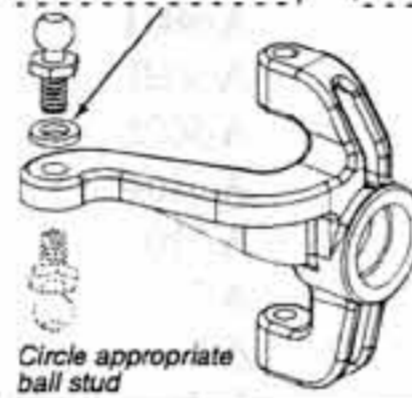

Rear Suspension

Notes: _____

Toe-In Inside _____ °
 Outside _____ °

Ride Height _____

Camber - _____ °
 + _____ °

Pivot Support _____ No Shim
 Shim Under Front Shim Under Rear

Sway Bar No
 Yes size _____

Rear Shocks

Oil: _____

Piston: _____ Standard / Drilled

Spring: _____

Limiters: Inside- _____ Outside- _____

Hole in Hub _____

Hole in Bulkhead _____

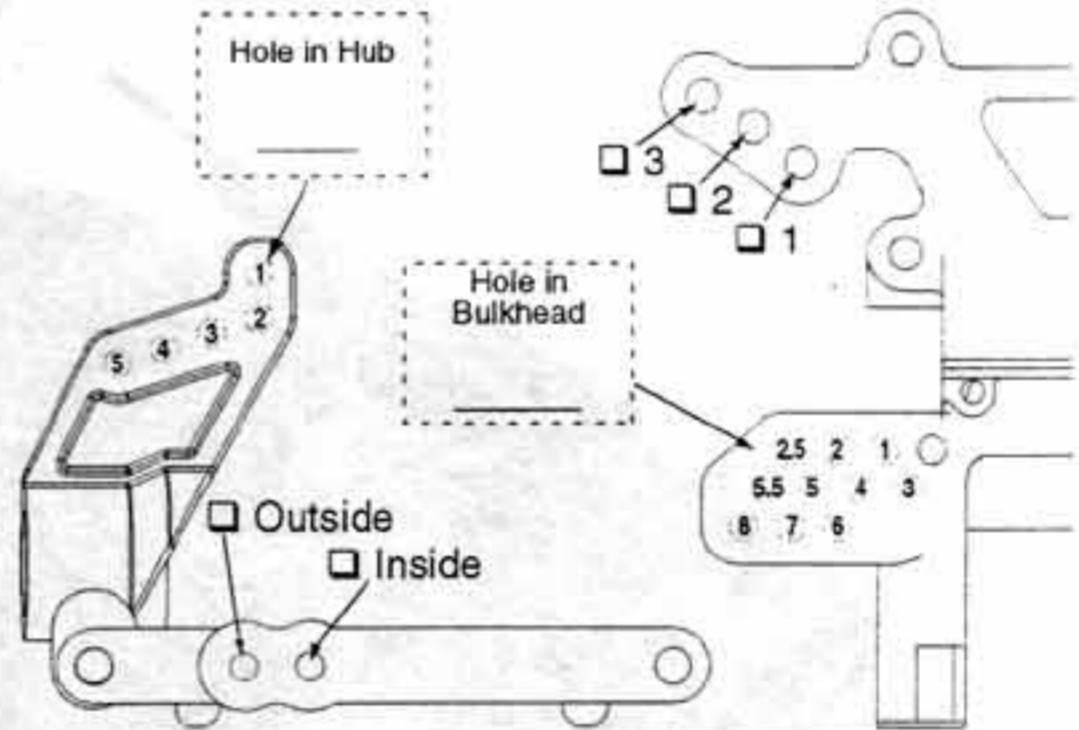

	Compound	Foam	Length
Front:	_____	_____	_____
Rear:	_____	_____	_____

Motor: _____
 Pinion: _____
 Spur: _____
 Tire Diameter: _____

Clicker Adjustment: Locked One-Way: _____

Battery Placement: Back Forward Other: _____

Transponder Position: _____

Notes: _____

Body: _____
 Wing: _____
 Size: _____