

TEAM LOSI XXT

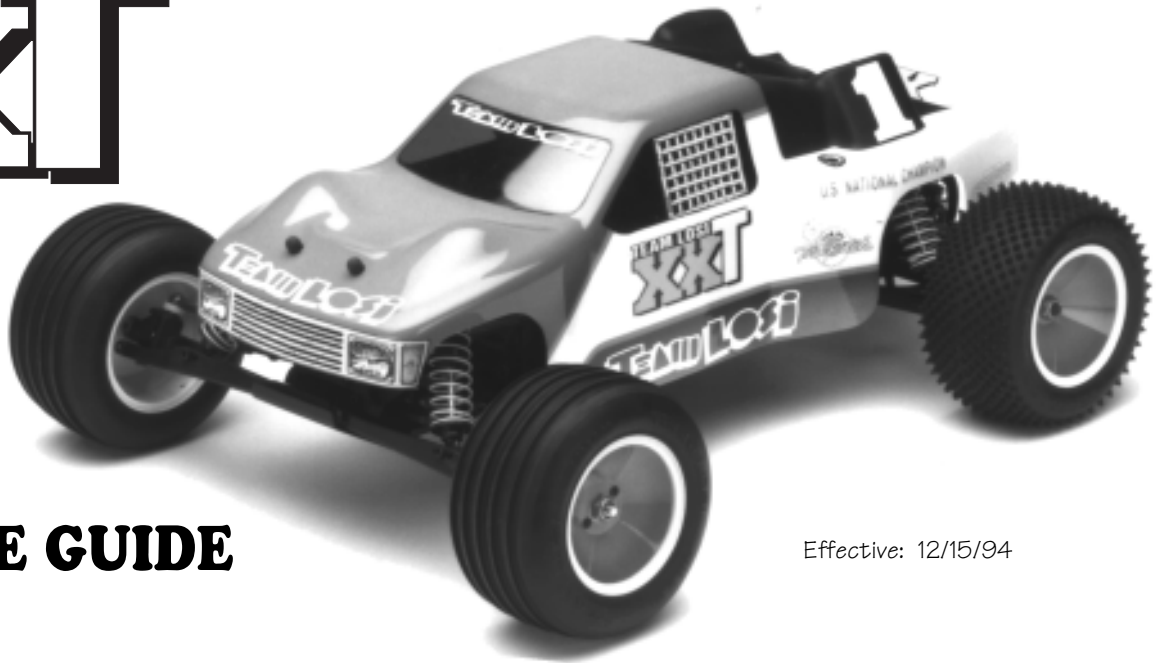

PRICE LIST REFERENCE GUIDE

Effective: 12/15/94

© 1995 TEAM LOSI, INC.

NOT RESPONSIBLE FOR TYPOGRAPHICAL ERRORS.

ALL PRICES SUBJECT TO CHANGE WITHOUT NOTICE

TEAM LOSI PERFORMANCE

A-0070	Double-XT Kit w/Bearings, Slipper & Hydra-Drive	1	\$349.95
A-1101	Front Bulkhead (XX,XXT)	1	5.00
A-1102	Front Bulkhead Brace for Inner Pin (XXT)	1	2.00
A-1108	Front Shock Tower (XXT)	1	6.00
A-1115	Front Suspension Arms (XXT)	2	7.50
A-1125	Front Spindles & Carriers (XXT)	4	6.00
A-1136	Front Axles (XXT)	2	6.00
A-1141	Pin Set for Front Bulkhead (upper & lower)	2	3.00
A-1149	Front Outer & King Pins 3/32" (XXT)	2	3.00
A-1601	Steering/Servo Mount Assy. (Molded) (XX,XXT)	1	6.00
A-1610	Steering Hardware Set (XX,XXT)	4	3.50
A-1615	Short Ball Cups & Threaded Rod (XX,XXT)	1	2.75
A-2005	Adjustable L/R Threaded Rods w/ends (1.125")	2	4.50
A-2006	Swivel Suspension Balls .250"	8	4.00
A-2007	Hinge Pin 1.42" (XXT)	2	3.00
A-2012	Assembly Wrench	1	1.50
A-2101	Rear Bulkhead	1	5.00
A-2110	Rear Pivot Support #2	1	4.00
A-2120	Rear Pivot Support #4	1	4.00
A-2125	Rear Hub Set	2	5.00
A-2140	Rear Suspension Arms (XXT)	2	7.50
A-2158	Rear Shock Tower (XXT)	1	6.00
A-2161	Inner rear Hinge Pins	2	3.00
A-2164	Outer Rear Hinge Pins	2	3.00
A-3014	Universal Pivots	2	4.50
A-3015	Rear Axle, Spacer & Pin	1	6.00
A-3016	Rear Axle Spacers	2	1.25
A-3045	Slipper Gear Cover Plug	4	1.50
A-3059	Trans Case Set 2.61:1 (XXT)	2	6.00
A-3060	Slipper Shaft, Spacer & Hardware	1	5.50
A-3061	Transmission Screw Set	4	2.00
A-3063	Motor Plate	1	8.00
A-3064	Gear Cover & Plug	1	2.50
A-3070	Differential Drive Rings	2	2.00
A-3071	Differential Thrust Bearing Assy	1	6.75
A-3072	Diff Tube	1	2.25
A-3073	Outdrive Cup	1	7.00
A-3076	Diff Gear only 2.61:1	1	2.00
A-3077	Upper Gear, Etc 2.61:1	1	6.00

CHOICE OF CHAMPIONS

A-3078	Diff Screw,Hardware & Seal	7	3.50
A-3080	Idler Gear 2.61:1	2	3.50
A-3083	Yoke & Screw for Dogbone/DriveShaft	2	3.50
A-3090	Dog Bone / DriveShaft w/Yoke (XXT)	1	8.50
A-3119	Hydra-Drive Housing Set	1	14.95
A-3122	Hydra-Drive / Friction Slipper Gear Plate	1	6.00
A-3123	Hydra-Drive / Friction Slipper Pad	1	3.00
A-3124	Hydra-Drive Slipper Spring, Cup, Spacer & Washer	1	3.00
A-3125	9/16" x 1/4" Thrust Bearing Assy	1	2.50
A-3126	Hydra-Drive Fluid "Standard"	1	3.00
A-3130	Hydra-Drive Rebuild Kit	1	9.95
A-3132	Slipper Back Plate (XX,XXT)	1	6.00
A-3908	88T Hydra-Drive / Slipper Gear	1	3.50
A-4002	Antenna Kit	1	2.25
A-4003	Antenna Caps	8	1.25
A-4004	Servo Tape	6	1.75
A-4010	Battery Strap Set	2	2.75
A-4015	Foam Battery Block Set (XX,XXT)	2	2.50
A-4056	Front Body Mount (XXT)	1	2.50
A-4102	Main Chassis (Long) w/Braces (XXT)	1	25.95
A-4110	Chassis Brace Set (XX,XXT)	1	6.00
A-4130	Front Bumper (XX,XXT)	1	3.00
A-5005	Shock Shaft .9"	1	3.00
A-5008	Upper Shock Mount Bushing	4	2.00
A-5015	Double O-Ring Shock Cartridge	1	2.00
A-5022	Shock Shaft 1.2"	1	3.00
A-5023	Spring Clamps & Cups	2	2.50
A-5030	.9" Shock Body Hard Anodized	1	8.00
A-5031	1.2" Shock Body Hard Anodized	1	8.00
A-5046	Teflon Shock Pistons #56 (Red)	4	3.00
A-5150	2.5" Spring 2.3 Rate (Pink)	2	2.50
A-5224	SILATECH Competition Shock Fluid 350 / 30 wt ..	1	3.50
A-6000	Studded Balls w/Rod Ends 4-40 X 3/8"	4	3.50
A-6001	Studded Balls w/Rod Ends 4-40 X 3/16"	4	3.50
A-6003	Foam Things (Linkage Rings)	8	1.50
A-6005	H.D. 30° Plastic Rod Ends	16	5.00
A-6038	Adjustable Threaded L/R Rod Set w/ends 2.25"	2	4.50
A-6040	Adjustable Threaded L/R Rod Set w/ends 2.5"	2	4.50
A-6100	E-Clips 1/8"	12	1.25

TEAM LOSI

Racing

TEAM LOSI XXT

13848 Magnolia Ave., Chino, CA 91710
Phone (909) 465-9400 Fax (909) 590-1496

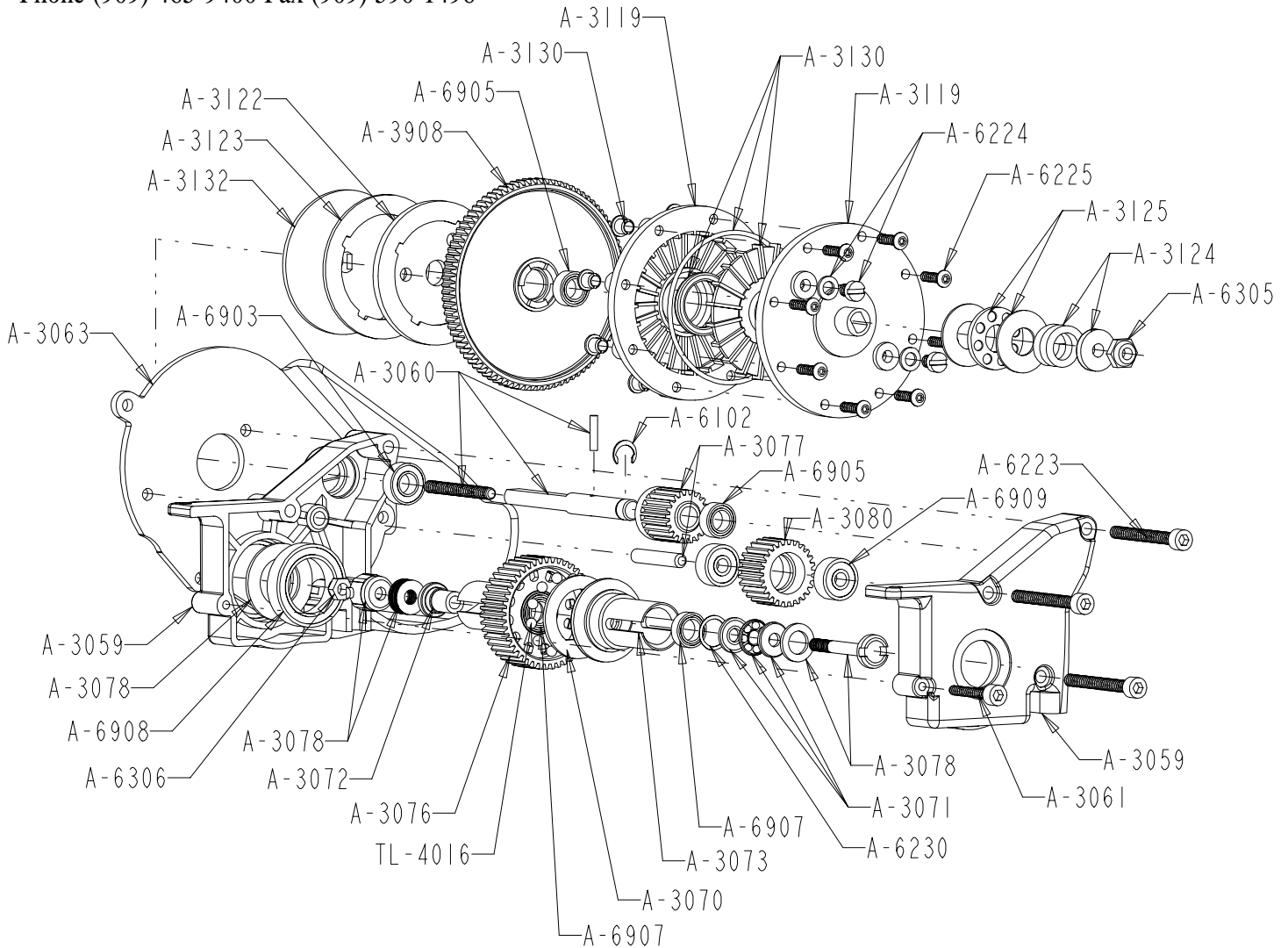

The Double-XT "Laydown" transmission

includes carbide balls, precision-grooved thrust assembly, hardened and polished diff rings and Teflon sealed outdrive bearings. The low CG design and precise gear profiles provide quicker acceleration and handling. The patented Hydra-Drive® is included for the ultimate in power handling and traction control.

Optional Parts For Double-XT Truck

A-4140	Sway Bar Kit	4	\$9.95
A-5148	2.75" Spring 2.0 rate (YELLOW)	2	2.50
A-9709	Graphite/Composite Front Arms	2	12.95
A-9721	Graphite/Composite Front Shock Tower	1	9.95
A-9805	2.5° Rear Hub Carrier Set	2	6.50
A-9809	Graphite/Composite Rear Arms	2	12.95
A-9821	Graphite/Composite Rear Shock Tower	1	9.95
A-9903	Graphite/Composite Long Chassis w/Braces	1	49.95
A-9920	Machined Lite Weight/Anodized Motor Plate	1	11.95
A-9932	Alum. Gear/Slipper Shaft 2.61:1 Ratio Hard Coated	1	11.95
A-9941	Bearing spacer / thrust plate set	2	9.95